

Thank you for purchasing the **Large Umbrella Stand**. This page lists all the contents included in the box. Please take time to identify the hardware as well as the individual components of this product. As you unpack and prepare for assembly, place the contents on a carpeted or padded area to protect them from damage. Note: 2 people are required to safely assemble this product.

## COMPONENTS

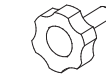

1 - knob



1 - post



1 - adaptor ring

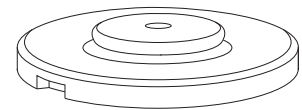

1 - base

## LARGE UMBRELLA ASSEMBLY (1.87" DIA)

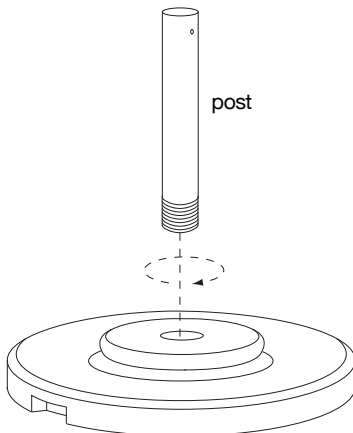

- ① Position **base** upright as shown. Insert threaded bolt of **post** into **base** as shown. Turn post clockwise to secure. Make sure post is securely engaged with base.

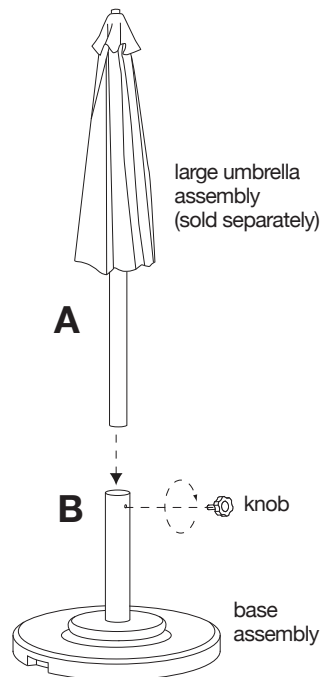

- ② A) With the assistance of another adult, fit pole of **large umbrella assembly** (sold separately) into corresponding hole of base assembly as shown. B) Insert **knob** into **base assembly** as shown. Turn knob clockwise to secure. Assembly is now complete.

## SMALL UMBRELLA ASSEMBLY (1.5" DIA)

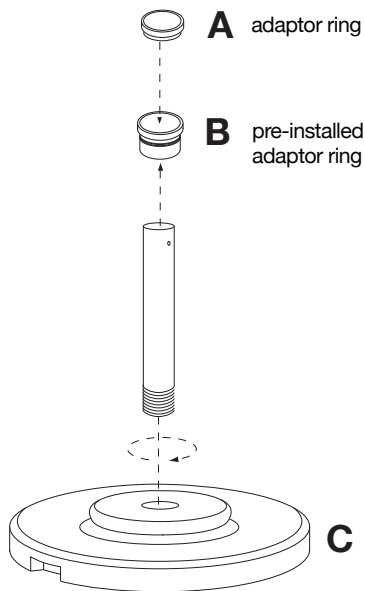

- ① A) Position **base** upright as shown. For the **small umbrella assembly** (sold separately), remove 1 **pre-installed adaptor ring** from **post** as shown.  
B) Fit 1 **adaptor ring** into **post** as shown.  
C) Insert threaded bolt of **post** into **base** as shown. Turn post clockwise to secure. Make sure post is securely engaged with base.

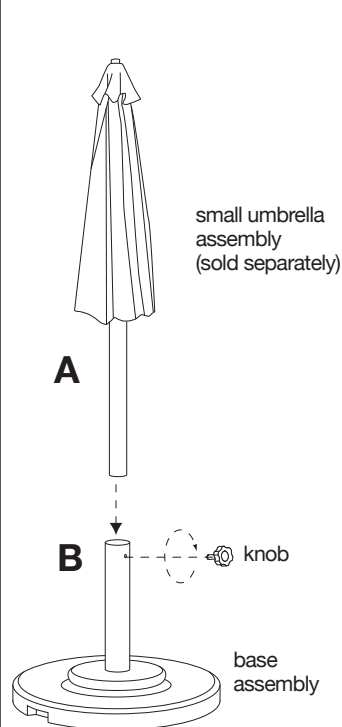

- ② A) With the assistance of another adult, fit pole of **small umbrella assembly** (sold separately) into corresponding hole of base assembly as shown.  
B) Insert **knob** into **base assembly** as shown. Turn knob clockwise to secure. Assembly is now complete.

## CLEANING & CARE

Clean surfaces with a dry or damp soft cloth.  
Do not use abrasive cleaners.