

Thank you for purchasing the **Puzzle Set of 2 Bookcase Connectors**. This page lists all the contents included in the box. Please take time to identify the hardware as well as the individual components of this product. As you unpack and prepare for assembly, place the contents on a carpeted or padded area to protect them from damage.

NOTE: These units are designed to be used in conjunction with the Puzzle Bookcase. Do not use these as stand-alone storage units.

HARDWARE



16 - cams



16 - cam screws



24 - wood dowels

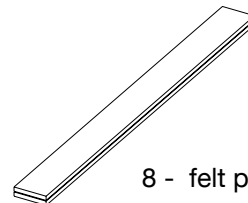

8 - felt pads

Missing hardware? Please call **800.606.6387** for replacements.

TOOLS REQUIRED

Phillips head screwdriver

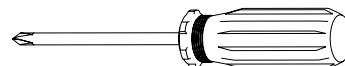

COMPONENTS

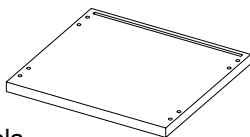

4 - short panels
(2 left, 2 right)

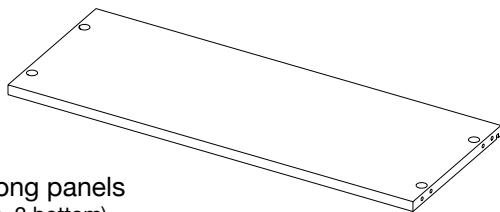

4 - long panels
(2 top, 2 bottom)

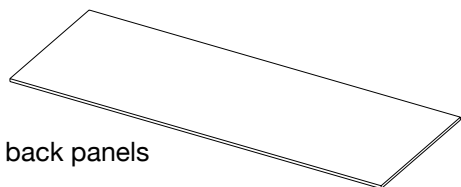

2 - back panels

IMPORTANT NOTE:

You will be building 2 identical units. The following instructions are for building a single unit, so these instructions will need to be repeated for assembly of the 2nd unit.

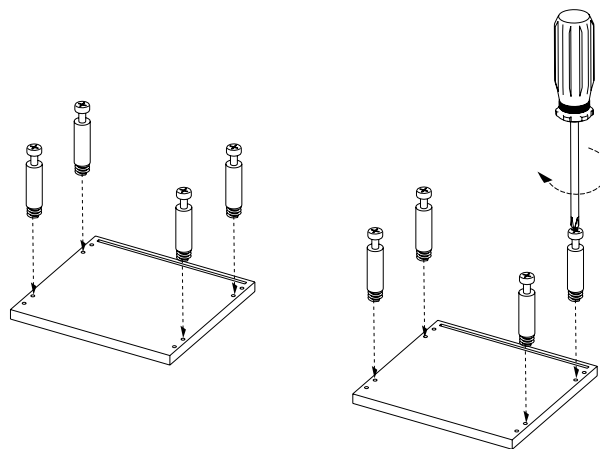

- 1 Place 2 **short panels** on the floor with the holes facing up. Insert 4 **cam screws** per panel into the inner holes and secure with a phillips head screwdriver.

x 2

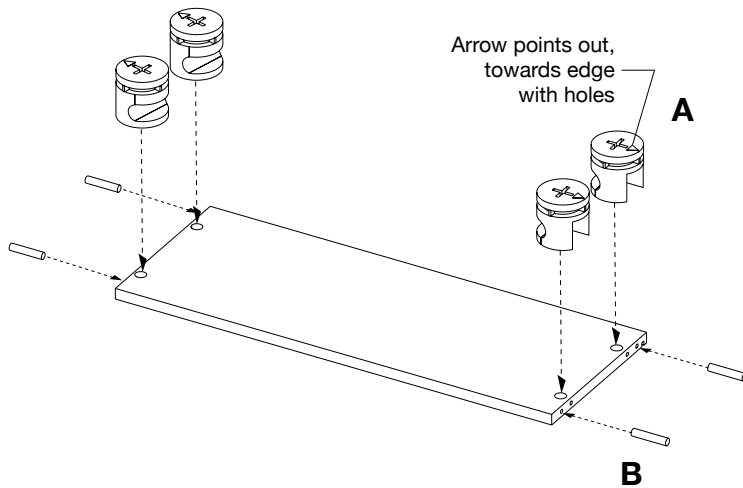

- ② A. Insert 4 **cams** into each **long panel**, making sure the arrow on the cam points out towards the edge with the holes.
B. Insert 4 **wood dowels** into the outer holes of each long panel.

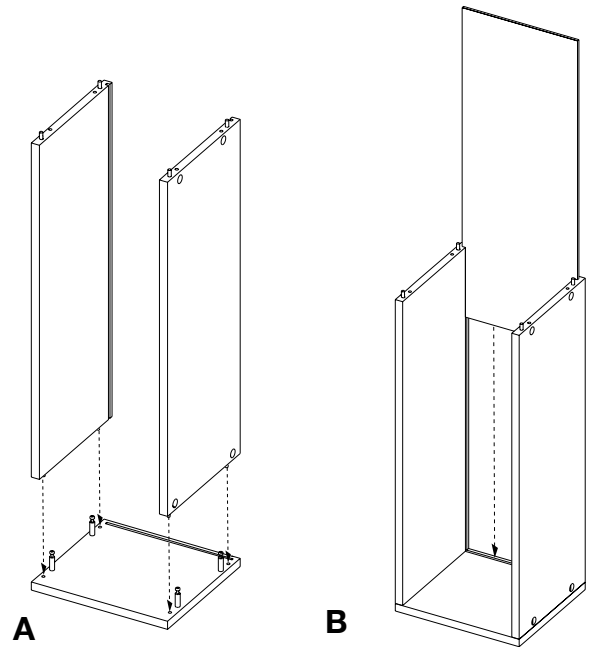

- ③ A. Align dowels of the 2 long panels with holes in 1 short panel and fit into position. Make sure the slot of each panel is at the rear of the assembly.
B. Slide **back panel** into the slot at the rear of the assembly.

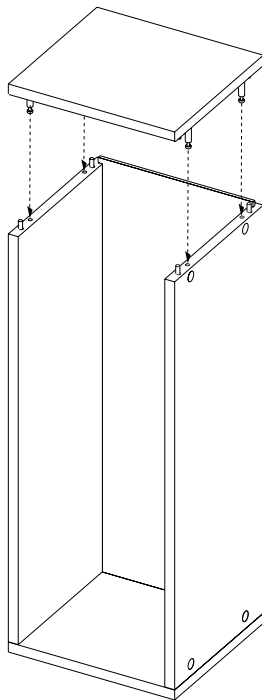

- ④ Place other **short panel** into position, aligning dowels, cam screws and back panel with corresponding holes and slot.

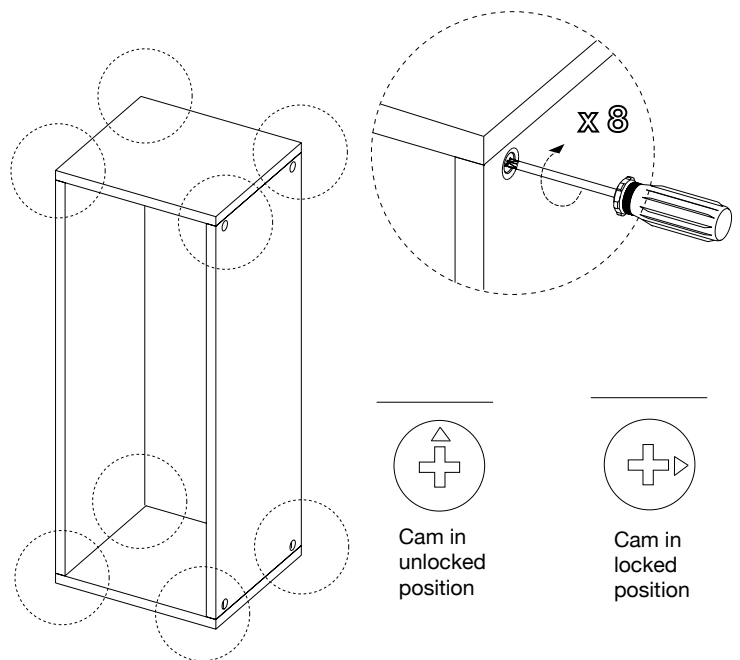

- ⑤ Secure the assembly by turning each **cam** 90 degrees clockwise with a screwdriver. Turn the cam until the arrow points away from the edge of the panel.

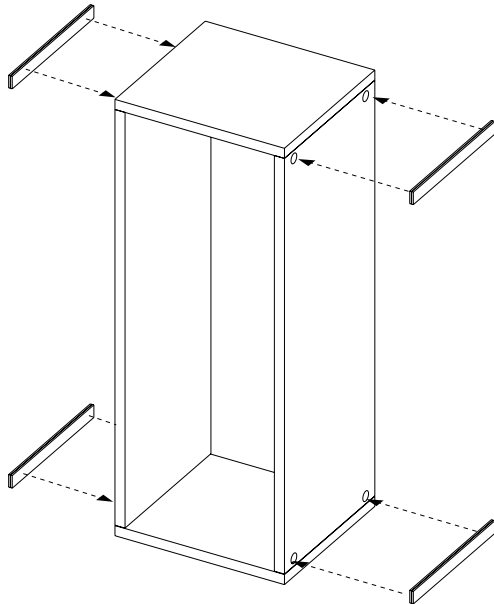

- ⑥ Remove adhesive backer from the 4 **felt pads** and attach to the long panels, covering the cam holes. Assembly is now complete.

CLEANING AND CARE

Clean surfaces with a dry or damp soft cloth. Do not use abrasive cleaners. Do not use furniture wax or polish.

CONFIGURATION SUGGESTIONS

Shown using 1 right facing bookcase, 1 left facing bookcase (sold separately) and 1 set of 2 connector units.

